



**ADDENDUM #1**  
**UKON WATER COMPANY**  
**450 WEST WATERLINE EXTENSION PROJECT**

The following changes are hereby made to the Contract Documents for the above referenced Project:

- **The following two items have been added to the Bid Schedule. The canal crossing will be a directional bore, no sleeve or open cut required. The updated Measurement and Payment for each item shall be revised as follows:**

**Obtain Required UDOT Encroachment Permit**

Obtaining all necessary UDOT encroachment permits. Payment shall be full compensation for applying and obtaining the permit together with complying with any and all UDOT requirements within the State Highway ROW during the course of construction.

**Directional Bore 10" HDPE DR11**

Horizontal directional drilled pipe of the type, size, and class listed in the Bidding Schedule and shown on the Drawings. Includes locating and protecting existing structures, utilities, and property, site preparation, excavation, dewatering, and backfill of pits, trench safety measures, installation and maintenance of drilling equipment, pilot hole construction, reaming, drilling fluid injection and management, pipe installation and fusing, post construction TV inspection and mandrel testing, pressure and leakage testing, flushing, and surface restoration.

This Addendum is hereby attached to and made part of the Bidding Documents and each Bidder shall acknowledge receipt of this Addendum on the Bid Form.

**BID SCHEDULE  
UKON WATER COMPANY  
450 WEST WATERLINE EXTENSION**

CONTRACTOR: \_\_\_\_\_

**BASE BID**

Item #	M&P Reference*	Bid Item Description	Estimated Quantity	Unit	Unit Price**	Bid Price
<b>450 WEST WATERLINE EXTENSION (OFF-SITE IMPROVEMENTS)</b>						
1	MP001	Mobilization	1	ls	\$	\$
2	MP002	UPDES Storm Water Regulations Compliance (Over One Acre)	1	ls	\$	\$
3	MP005	Traffic Control	1	ls	\$	\$
4	MP007	Construction Staking	1	ls	\$	\$
5	MP310	Plug Abandoned Waterline	1	ea	\$	\$
6	MP600	Saw Cut Asphalt	800	lf	\$	\$
7	MP602	Remove Asphalt	4,000	sf	\$	\$
8	MP311	New Waterline	9,280	lf	\$	\$
9	MP314	Waterline Loop	2	ea	\$	\$
10	MP315	1" Poly Water Service	575	lf	\$	\$
11	MP319	New 8" Gate Valve	2	ea	\$	\$
12	MP317	Connect New Service to Ex. Meter	13	ea	\$	\$
13	MP325a	New Water Meter Box & Assembly	17	ea	\$	\$
14	MP323	New Air/Vac Valve Station	4	ea	\$	\$
15	MP326a	New Blow-Off Assembly	1	ea	\$	\$
16	MP313	Waterline Connection (8"X8" tee w/ 8"x4" reducer)	1	ea	\$	\$
17	MP313	Waterline Connection (8"X8" tee w/ 8"x6" reducer)	1	ea	\$	\$
18	MP313	Waterline Connection (8"X4" tee)	1	ea	\$	\$
19	MP612	Asphalt Patch (3" HMA, 8" UTBC)	4,000	sf	\$	\$
20	MP613	Raise Valve to Grade	1	ea	\$	\$
21		Obtain required UDOT Encroachment permit	1	ls	\$	\$
22	MP814	Directional Bore 10" HDPE DR11	250	lf	\$	\$
<b>450 WEST WATERLINE EXTENSION (ON-SITE IMPROVEMENTS)</b>						
23	MP316	Connect to Ex. Water Service Line	17	ea	\$	\$
24	MP317	Connect to New Water Meter	17	ea	\$	\$
25	MP319	New Shutoff Valve	9	ea	\$	\$
26	MP320	New Freezeless Yard Hydrant	17	ea	\$	\$
27	MP315a	1" Poly Water Service Pipe (Share)	2,655	lf	\$	\$

28	MP315b	1" Poly Water Service Pipe	846	lf	\$	\$
29	MP327a	Water Service Shared Trench	665	lf	\$	\$
30	MP822a	Temp Relocate Exist Propane Tank	4	ea	\$	\$
31	MP823a	Temp Relocate Existing Shed	8	ea	\$	\$

**450 West Waterline Extension Total Base Bid (Items# 1-31): \$ \_\_\_\_\_**

**Additive Alternates**

Item #	M&P Reference*	Bid Item Description	Estimated Quantity	Unit	Unit Price**	Bid Price
AA1	MP319a	Remove & Replace 4" Gate Valve (100 North)	2	ea	\$	\$

**\*To go directly to Measurement and Payment click here.**

**\*\*Unit Price shall contain no more than 2 decimal points (e.g., \$0.00)**

Bidder acknowledges that (1) each Bid Unit Price includes an amount considered by Bidder to be adequate to cover Contractor's overhead and profit for each separately identified item, and (2) estimated quantities are not guaranteed, and are solely for the purpose of comparison of Bids, and final payment for all unit price Bid items will be based on actual quantities, determined as provided in the Contract Documents.

1.9 DESCRIPTION OF BID ITEM

M&P Reference	Bid Item	Unit	Payment Includes	Notes
MP001	Mobilization	LS	All costs associated with mobilizing and demobilizing equipment and materials to and from the project site, mobilization, demobilization, establishment of offices, buildings, all OSHA required safety measures, sanitation, and other facilities necessary for the Work, bonds, snow removal, dust control, fees, permits (not specified as paid for elsewhere), administrative services, construction notifications, identifying and marking of construction limits and all costs associated with the Work that are not included in other bid items.	
MP002	UPDES Storm Water Regulations Compliance (Over One Acre)	LS	Compliance with the requirements of the Utah Pollutant Discharge Elimination System (UPDES) program including the Construction General Permit. Compliance includes the preparation of, and amendments to, a Storm Water Pollution Prevention Plan (SWPPP) by the Contractor, or authorized representative. Preparing a complete SWPPP including filing a Notice of Intent (NOI) to begin the project and filing a Notice of Termination (NOT) at the conclusion of the project, maintenance, inspections, and any other work necessary to comply with the SWPPP. Best management practices such as storm water gravel inlet sediment filters, silt fencing, erosion control mats, wash down pads, containment pads, dust abatement, regular clean-up, street sweeping, etc. Includes applications, permits, notifications, and other correspondence associated with the permit process. This item shall cover all aspects of construction.	A recommended SWPPP template can be found on the State's Department of Environmental Quality website.

**MEASUREMENT AND PAYMENT**

---

<b>MP005</b>	Traffic Control	LS	All traffic control needed on the job. Includes state and local permitting, sub-contractor mobilization, barricades, traffic signs, portable construction message boards, flaggers, other channelizing devices, and all other measures needed to channel traffic and to protect construction personnel and the public (vehicular and pedestrian) from harm resulting from any construction activities. Necessary notifications to public transportation and emergency service agencies with appropriate notice. Maintain reasonable continuous vehicular and pedestrian access for local residents/businesses throughout the duration of the project, including any notifications needed to communicate construction activities to the local residents/businesses. Preparation and on-going modification of a traffic control plan.	
<b>MP007</b>	Construction Staking	LS	Preparation for and placement of construction stakes necessary to construct the Project. Staking shall include, but not be limited to project limits, right-of-way, easements, centerline, grading, paving, utility piping, fittings, hydrants, valves, bends, manholes, inlet boxes, services, laterals, culverts, structures, fencing, cross sections of all stockpiles, final cross sections for earthwork quantities, reestablishing plan benchmarks, monuments and property corners, setting additional benchmarks as needed, and miscellaneous construction survey work.	The Engineer will provide project design CAD files to the Contractor as requested.
<b>MP310</b>	Plug Abandoned Water Line	ea	Locating of existing pipe, unclassified excavation, dewatering, removal of thrust blocks where present, cutting of pipe, plugging the end of the existing pipe with a leak-proof fitting assembly, backfill to grade, and compaction.	

<p><b>MP311</b></p>	<p>New Water Line</p>	<p>If</p>	<p>Piping of the type, size and class shown on the Drawings. No classification of excavated materials shall be made, and excavation shall include the removal and subsequent handling of all earth, shale, loose or cemented gravel, loose rock, solid rock, or other materials of whatever nature excavated or otherwise removed in the performance of the project work, dewatering, trench safety measures, lawful disposal of excess material, backfill to grade, compaction, foundation sand, pipe bedding, fittings (tees, bends, reducers, sleeves, couplings, etc.), corrosion protection (bolts, polywrap, etc. - as specified), marking tape, tracer wire when required, thrust restraint, grade controls, all necessary pothole investigation of existing utilities to predetermine any conflicts with other utilities or structures (horizontal or vertical), coordination with Engineer for resolution of predetermined conflicts, flushing, pressure testing, correction of any material or installation-related defect, disinfection, high chlorine removal, and restoration of miscellaneous improvements damaged as a result of completing this item.</p>	<p><i>No payment will be given for the relaying of pipe that could have been avoided through potholing and conflict resolution with the Engineer, nor for the laying of pipe out of sequence. Making adjustments to other pipes or structures in conflict will only be allowed if pipe grade adjustments to the new pipe cannot be made.</i></p> <p><i>Removal of pavement, installation of imported backfill (if required), and installation of new pavement section is paid for under separate items.</i></p>
---------------------	-----------------------	-----------	---------------------------------------------------------------------------------------------------------------------------------------------------------------------------------------------------------------------------------------------------------------------------------------------------------------------------------------------------------------------------------------------------------------------------------------------------------------------------------------------------------------------------------------------------------------------------------------------------------------------------------------------------------------------------------------------------------------------------------------------------------------------------------------------------------------------------------------------------------------------------------------------------------------------------------------------------------------------------------------------------------------------------------------------------------------------------------------------------------------------------------------------------------------------------	-----------------------------------------------------------------------------------------------------------------------------------------------------------------------------------------------------------------------------------------------------------------------------------------------------------------------------------------------------------------------------------------------------------------------------------------------------------------------------------------------------------------

**MEASUREMENT AND PAYMENT**

---

<b>MP313</b>	Water Line Connection (Hot Tap)	ea	Installation of water line connection via hot tap complete as shown on the Drawings. Includes unclassified excavation, dewatering, backfill to grade, compaction, tapping sleeve and saddle, valve, valve box and lid, tapping of pipe, other required fittings to make a leak-proof connection, foundation sand, corrosion protection, thrust restraint, handling of all active water flows, and restoration of miscellaneous improvements damaged as a result of completing this item.	<i>Raising to grade with concrete collar paid for under a separate item.</i>
<b>MP314</b>	New Water Line Loop	ea	Looping of water line. Includes piping, bends, fittings, and thrust restraint as specified in the Drawings, excavation, dewatering, trench safety measures, cutting of pipe, lawful disposal of excess material, backfill to grade, compaction, foundation sand, pipe bedding, corrosion protection, tracer wire when required, grade controls, all necessary pothole investigation of existing utilities to determine conflicts, coordination with Engineer for resolution of conflicts, and restoration of miscellaneous improvements damaged as a result of completing this item.	

**MEASUREMENT AND PAYMENT**

<p><b>MP315</b></p>	<p>New Water Service Line</p>	<p>If</p>	<p>Piping of the type, size and class shown on the Drawings. No classification of excavated materials shall be made, and excavation shall include the removal and subsequent handling of all earth, shale, loose or cemented gravel, loose rock, solid rock, or other materials of whatever nature excavated or otherwise removed in the performance of the project work, dewatering, trench safety measures, lawful disposal of excess material, backfill to grade, compaction, foundation sand, pipe bedding, fittings, couplings, connection to meter assembly, corrosion protection, tracer wire when required, grade controls, all necessary pothole investigation of existing utilities to predetermine any conflicts with other utilities or structures (horizontal or vertical), coordination with Engineer for resolution of predetermined conflicts, flushing, correction of any material or installation-related defect, disinfection, high chlorine removal, and restoration of miscellaneous improvements damaged as a result of completing this item.</p>	<p><i>Removal of pavement, installation of imported backfill (if required), and installation of new pavement section is paid for under separate items.</i></p>
<p><b>MP315a</b></p>	<p>1" Poly Water Service Pipe (in shared trench)</p>	<p>If</p>	<p>Work completed under this bid item shall be paid for at the contract unit bid price per lineal foot listed in the bidder's proposal and shall be considered complete compensation for all labor, equipment, and materials necessary, including but not limited to: furnishing and installing the 1-inch diameter polyethylene DR9 CTS pipe (200 psi) with stainless steel inserts, and PVC pipe spacers; commissioning of water service (including cleaning and flushing, disinfection and pressure testing); and all other operations and materials required to complete the item in accordance with the plans, technical specifications, and UKON Water Company standards.</p>	<p><i>This bid item does not include excavation or backfill of the trench, which is covered under a separate Bid Item . This bid item only includes the pipe installation where two or more service lines are being installed in the same trench.</i></p>



<p><b>MP315b</b></p>	<p>1" Poly Water Service Pipe (in individual trench)</p>	<p>If</p>	<p>Work completed under this bid item shall be paid for at the contract unit bid price per lineal foot listed in the bidder's proposal and shall be considered complete compensation for all labor, equipment, and materials necessary, including but not limited to: providing video/photos of existing condition prior to work; clearing, grubbing, and stripping; excavation; dewatering; shoring; removal and disposal of excavated material; furnishing and installing the 1-inch diameter polyethylene DR9 CTS pipe (200 psi) with stainless steel inserts; commissioning of water service (including cleaning and flushing, disinfection and pressure testing); furnishing, installing, and removing temporary blow-off valves and fittings required for pipeline commissioning; protection of buried utilities; additional potholing as needed; backfilling with import pipe zone material and import trench backfill material; compaction; surface restoration incidental to construction activities associated with this bid item to existing or better condition; and all other operations and materials required to complete the item in accordance with the plans, technical specifications, and UKON Water Company standards. The Contractor shall protect all existing facilities and improvements whether temporary or permanent; including but not limited to: sidewalks, turf, bushes, trees, mailboxes, sewer laterals, septic tanks, risers and access lids, trailers, sheds (unless noted otherwise), propane tanks (unless noted otherwise), BBQ grills, tables, chairs, personal property items, sports equipment, etc.</p>	<p><i>This bid item does not include excavation or backfill of the trench, which is covered under a separate Bid Item.</i></p>
----------------------	----------------------------------------------------------	-----------	----------------------------------------------------------------------------------------------------------------------------------------------------------------------------------------------------------------------------------------------------------------------------------------------------------------------------------------------------------------------------------------------------------------------------------------------------------------------------------------------------------------------------------------------------------------------------------------------------------------------------------------------------------------------------------------------------------------------------------------------------------------------------------------------------------------------------------------------------------------------------------------------------------------------------------------------------------------------------------------------------------------------------------------------------------------------------------------------------------------------------------------------------------------------------------------------------------------------------------------------------------------------------------------------------------------------------------------------------------------------------------------------------------------------------------------------------------------------------------------------------------------------------------------------------------------------------------------------------------------------------------------------------	--------------------------------------------------------------------------------------------------------------------------------

**MEASUREMENT AND PAYMENT**

---

<b>MP316</b>	Connect to Existing Water Service Line	ea	Payment for the new connection shall be made at the contract unit bid price for completion of the work shown on the Contract Drawings and specified herein. Payment shall be considered complete compensation for all labor, equipment, and materials, including but not limited to: cutting, removing and disposing of existing water service line as necessary; furnishing and installing reducer coupler; and all other operations and materials required to complete the item in accordance with the plans, technical specifications, and UKON Water Company standards.	
<b>MP317</b>	Water Service Line Connection (to Meter)	ea	Connection of water service line to water meter complete as shown on the Drawings. Includes unclassified excavation, dewatering, backfill to grade, compaction, connection to meter assembly, fittings required to make a leak-proof connection, foundation sand, corrosion protection, handling of all active water flows, and restoration of miscellaneous improvements damaged as a result of completing this item.	
<b>MP319</b>	New Water Valve	ea	Installation of new water valve of the type, size, and class shown in the Drawings, unclassified excavation, dewatering, backfill to grade, compaction, foundation sand, fittings, corrosion protection, thrust restraint, adjusting to finish grade, and restoration of miscellaneous improvements damaged as a result of completing this item.	<i>Raising to grade with concrete collar paid for under a separate item.</i>
<b>MP319a</b>	Remove and Replace Exist Valve	ea	Removing and replacing an existing water valve as indicated on the drawings and as directed by the Water company. Includes unclassified excavation, dewatering, replacing and salvage/disposing of old valve as directed by the Owner, all parts and install for new valve and all work associated to complete the item.	Raising to grade with concrete collar paid for under a separate item.

**MEASUREMENT AND PAYMENT**

---

<b>MP320</b>	New Freezeless Yard Hydrant	ea	Payment for the new yard hydrant shall be made at the contract unit bid price for completion of the work shown on the Contract Drawings and specified herein. Payment shall be considered complete compensation for all labor, equipment, and materials, including but not limited to: excavation; dewatering; shoring; removal and disposal excavated material; furnishing and installing yard hydrant assembly, coupler, bends, gravel, filter fabric; connection to existing water service; protection of buried utilities; additional potholing as needed; backfilling with import pipe zone material and import trench backfill material; compaction; surface restoration incidental to construction activities associated with this bid item to existing or better condition; and all other operations and materials required to complete the item in accordance with the plans, technical specifications, and UKON Water Company standards.	
<b>MP323</b>	New Air/Vac Valve Station	ea	Installation of new air/vac valve station complete as shown on the Drawings. Includes unclassified excavation, dewatering, backfill to grade, compaction, connections and piping to water line, valve box and lid, venting components and protective cover, all required fittings, handling of all active water flows, adjusting to final grade, and landscape surface restoration (top soil, grassed areas, sprinkler systems, plants, mulch, rock, etc.).	<i>Raising to grade with concrete collar paid for under a separate item.</i>
<b>MP325a</b>	New Water Meter Box and Assembly	ea	Installation of new meter box and assembly complete as shown on the Drawings. Includes unclassified excavation, dewatering, backfill to grade, compaction, connections to water service line and meter assembly, meter box and lid as specified, all required fittings, valves, handling of all active water flows, adjusting to final grade, and landscape surface restoration (top soil, grassed areas, sprinkler systems, plants, mulch, rock, etc.).	Meter Furnished by City, Curb markers

**MEASUREMENT AND PAYMENT**

<b>MP326a</b>	New Blow Off	ea	Installation of blow-off box and assembly complete as shown on the Drawings. Includes unclassified excavation, dewatering, backfill to grade, compaction, pipe bedding sand, gravel, box and lid, fittings, thrust restraint, adjusting to final grade, handling of all active water flows, and landscape surface restoration (top soil, grassed areas, sprinkler systems, plants, mulch, rock, etc.).	Raising to grade with concrete collar paid for under a separate item.
<b>MP327a</b>	Water Service Shared Trench	lf	Work completed under this bid item shall be paid for at the contract unit bid price per lineal foot listed in the bidder's proposal and shall be considered complete compensation for all labor, equipment, and materials necessary, including but not limited to: providing video/photos of existing condition prior to work; clearing, grubbing, and stripping; excavation; dewatering; shoring; removal and disposal of excavated material; protection of buried utilities; additional potholing as needed; backfilling with import pipe zone material and import trench backfill material; compaction; surface restoration incidental to construction activities associated with this bid item to existing or better conditions; and all other operations and materials required to complete the item in accordance with the plans, technical specifications, and UKON Water Company standards. The Contractor shall protect all existing facilities and improvements whether temporary or permanent; including but not limited to: sidewalks, turf, bushes, trees, mailboxes, sewer laterals, septic tanks, risers and access lids, trailers, sheds (unless noted otherwise), propane tanks (unless noted otherwise), BBQ grills, tables, chairs, personal property items, sports equipment, etc.	<i>This bid item does not include furnishing and installing the water service piping, which is covered under separate bid item. This bid item only applies for trenches where two or more water service lines are being installed together.</i>

**MEASUREMENT AND PAYMENT**

<b>MP600</b>	Saw Cut Asphalt	lf	Saw cutting asphalt up to 6" thick as shown on the Drawings. Includes utility locating and protection, saw cutting, and water.	<i>Thicknesses greater than 6" shall be paid based on proportional thickness, calculated by dividing the unit price by 6" to get a \$/in depth cost, then multiplying by the actual thickness cut.</i>
<b>MP602</b>	Remove Asphalt	sf	Asphalt removal as shown on the Drawings. Includes removal of asphalt including concrete collars where present, loading, haul, and lawful disposal.	<i>See Bidding Schedule and/or Drawings for approximate thickness.</i>
<b>MP612</b>	Asphalt Patch (3" HMA, 8" UTBC)	sf	Patching of removed asphalt areas as shown on the Drawings or as directed by an authorized Owner representative. Includes preparation, grading, and compaction of underlying subgrade, application of tack coat on a clean asphalt edge, loading, haul, installation and compaction of UTBC and HMA.	<i>Saw cutting and removal of asphalt and road base is paid for under a separate item.</i>
<b>MP613</b>	Raise Valve to Grade with Concrete Collar	ea	Raising manholes, valves, boxes and/or monuments to grade as shown on the Drawings. Includes removal and lawful disposal of asphalt and cover material, excavation, cleaning out of any excess material inside manhole, valve, box, or monument; backfill, compaction, saw cutting edge of asphalt for concrete collar, grade rings, replacement of removed items to finished grade, constructing concrete collar, protection, and traffic control until concrete has had suitable time to cure. Monuments to be reestablished by a licensed surveyor including any recordation fees.	

**MEASUREMENT AND PAYMENT**

---

<b>MP822a</b>	Temporarily Relocate Existing Propane Tank	ea	Payment for the temporarily relocate existing propane tank shall be made at the contract unit bid price for completion of the work shown on the Contract Drawings and specified herein. Payment shall be considered complete compensation for all labor, equipment, and materials, including but not limited to: coordination with owner; providing video/photos of existing condition prior to work; disconnection and reconnection of service lines to trailer; protection of the existing tank; relocating tank to install new water service; returning tank to original location; and all other operations and materials required to complete the item in accordance with the plans, and technical specifications.	
<b>MP823a</b>	Temporarily Relocate Existing Shed	ea	Payment for the temporarily relocate existing shed shall be made at the contract unit bid price for completion of the work shown on the Contract Drawings and specified herein. Payment shall be considered complete compensation for all labor, equipment, and materials, including but not limited to: coordination with owner; providing video/photos of existing condition prior to work; protection of the existing shed; relocating shed to install new water service; returning shed to original location; and all other operations and materials required to complete the item in accordance with the plans, and technical specifications.	
	Obtain Permits	ea	Obtaining all necessary UDOT encroachment permits. Payment shall be full compensation for applying and obtaining the permit together with complying with any and all UDOT requirements within the State Highway ROW during the course of construction.	

<p><b>814</b></p>	<p>Directional Drilled Pipe</p>	<p>If</p>	<p>Horizontal directional drilled pipe of the type, size, and class listed in the Bidding Schedule and shown on the Drawings. Includes locating and protecting existing structures, utilities, and property, site preparation, excavation, dewatering, and backfill of pits, trench safety measures, installation and maintenance of drilling equipment, pilot hole construction, reaming, drilling fluid injection and management, pipe installation and fusing, post construction TV inspection and mandrel testing, pressure and leakage testing, flushing, and surface restoration.</p>	<p><i>Contractor shall be responsible for removal and disposal of drill fluid breakouts. Damage resulting from the drilling activities shall require complete restoration to the satisfaction of the Owner. Any adaptors or couplings necessary for placement of fittings and valves shall not be paid for separately. No separate payment will be made for cleanup or restoration due to damage caused by Contractor's operations.</i></p>
-------------------	---------------------------------	-----------	---------------------------------------------------------------------------------------------------------------------------------------------------------------------------------------------------------------------------------------------------------------------------------------------------------------------------------------------------------------------------------------------------------------------------------------------------------------------------------------------------------------------------------------------------------------------------------------------	---------------------------------------------------------------------------------------------------------------------------------------------------------------------------------------------------------------------------------------------------------------------------------------------------------------------------------------------------------------------------------------------------------------------------------------------

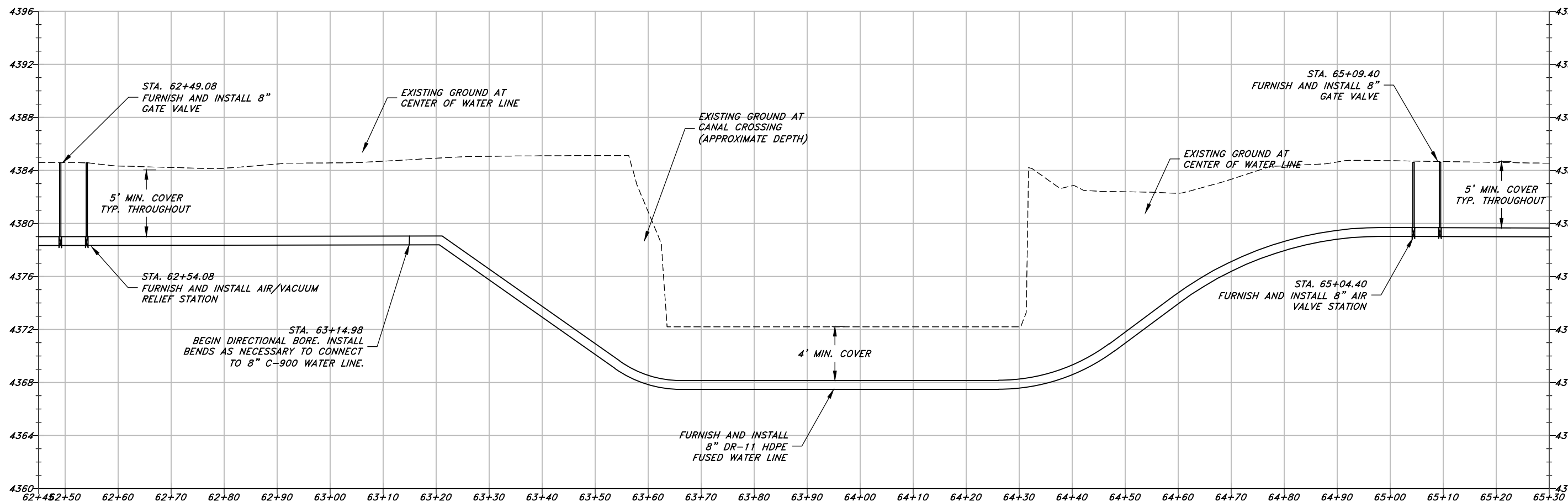

NO.	DATE	BY	CHKD.	APPR.